

Slim KOMBAT & Slim HTE-HTE SR-HVLP

IDEAL FOR PRIMERS AND FINISHES IN BODYSHOPS AND INDUSTRIAL PAINTING

IDEAL FOR PRIMERS AND FINISHES IN BODYSHOPS AND INDUSTRIAL PAINTING

For over a decade SLIM has been synonymous with quality, reliability and versatility, appreciated all over the world of painting: from Car Refinish to Industry, to Woodworking.

Today Slim is joined by Slim KOMBAT, a new, unique and revolutionary version of the airbrush that has made the history of Walcom®.

Slim KOMBAT breaks the production mould, abandons the classic aluminum body and presents itself with an innovative magnesium body, injected with Kevlar® fiber (PAT. PENDING)

The lightness of magnesium, combined with the compactness and strength of Kevlar®, give life to an airbrush weighing only 380 g, also improved in performance, thanks to the new bodies and more powerful and concentrated air flows that allow better product atomization.

The characteristics of Kevlar® make this spray gun absolutely resistant to the aggressions of any type of solvent and pickling agent.

The surface characteristics also make it extremely easy to clean.

Slim KOMBAT is therefore added to the traditional Slim and is available in 3 versions: HVLP, HTE, HTE SR, which share the same air consumption (220-260 l/min), high transfer efficiency (over 80% for primers and 70% for bases and clear) and for the quality in product distribution and atomization.

Recommended nozzle Ø table,
see www.walcom.com

PAINTING DISTANCE

Between 10 and 15 cm for the HVLP version.

Between 15 and 20 cm for the HTE version, guarantees improved product layout on painted parts.

BOX

Cardboard box package includes: sprayguns, rebuild kit (spring, seals, air valve) wrench tool, mineral lube oil, instruction manual and warranty.

SUITCASE

Rigid plastic suitcase includes: spraygun, air control with gauge, rebuild kit (spring, seals, air valve), cup, wrench tool, mineral lube oil, instruction manual and warranty.



- 1 AIR ADJUSTMENT**
Completely open for total air flow.
- 2 AIR INLET PRESSURE**
2 bar for HVLP and HTE version.
- 3 FAN PATTERN CONTROL**
Completely open for ideal paint atomization.
- 4 MATERIAL FLOW CONTROL**
From 3.5 to 4.5 turns. Subjective value and therefore modifiable according to the user's habits.



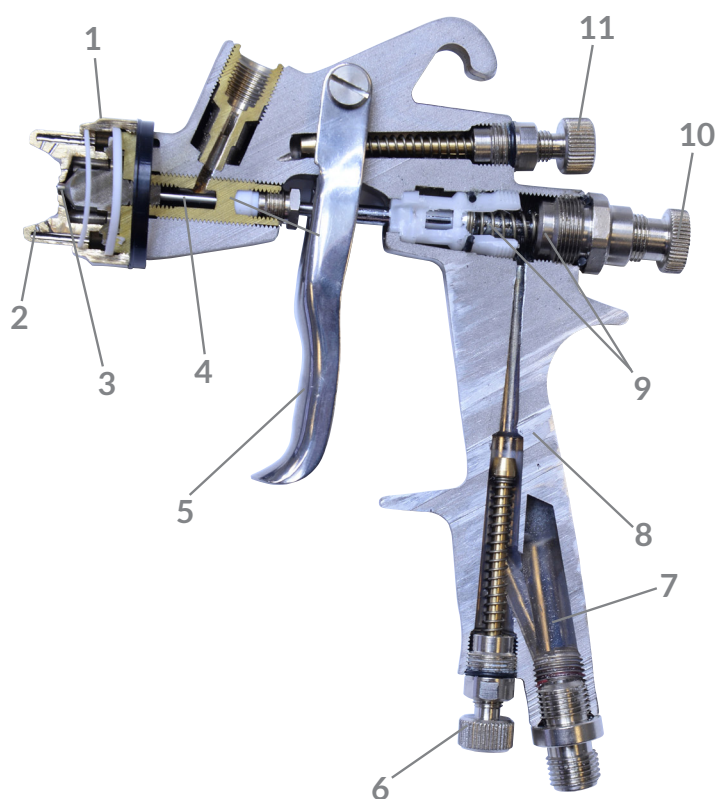

SLIM/ SLIM KOMBAT: product and specifications section

The spray gun is constructed with air valve and needle on a single axis to provide higher performance and greater.

- 1 Chrome plated brass nut / Kevlar fiber nut.
- 2 Chemical nickel-plated brass cap.
- 3 Stainless steel nozzle.
- 4 Stainless steel needle.
- 5 Polished stainless steel ergonomic lever/ Kevlar fiber lever.
- 6 Air flow regulation knob.
- 7 Calibrated air passages.
- 8 Polished and chrome-plated aluminium body for total protection/ Magnesium and Kevlar fiber body.
- 9 PTFE (Teflon) gaskets and valve, resistant to all water and solvent based paints with automatic adjustment system.
- 10 Product opening knob.
- 11 Fan adjustment knob.



- 1 **BODY:**
Chemical nickel plated and polished aluminium. Finishing treatments make it resistant to solvents. The particular slim shape makes the spray gun ergonomic and easy to use / Die-casting magnesium over-injected kevlar fiber.
- 2 **NOZZLE:**
Monobloc stainless steel unit. The holes for diffusion provide a constant and high volume air flow to the cap.
- 3 **AIR CAP:**
Chemical nickel-plated brass guarantees precision and maximum durability. The processing precision of this material provides constant and high level atomization levels.
- 4 **NEEDLE:**
CNC processed stainless steel for maximum durability and guaranteed precision in nozzle alignment.

TYPE

ITEM ID

RECOMMENDED USE

Slim KOMBAT HTE

Cup: POM C 680 cc

Ref. 8030**

Cup: aluminium 750 cc

Ref. 8035**

Cup: plastic gray cup anti-UV 680 cc

Ref. 8030**/UV

- Body: die-casting magnesium and Kevlar fiber
- Trigger: Kevlar fiber
- Air cap: chemically nicked plated brass
- Air cap ring: Kevlar fiber
- Nozzle: AISI 303 stainless steel
- Needle-spring: stainless steel
- Seal gaskets: self-lubricating and adjustable PTFE (Teflon)

• **Weight: 380 g**

• Operating air pressure: 2.0 - 2.5 bar

• Air consumption: 265 - 290 l/min

• Ø nozzle: 1.0 - 1.2 - 1.3 - 1.5 - 1.7 - 1.9 - 2.2 - 2.5

Air inlet pressure regulator with pressure gauge



BASE COAT
CLEAR COAT
PRIMER

Note:
add nozzle Ø to Ref. (**)



Slim KOMBAT HTE

Cup: POM C 680 cc

Ref. 8020**

Cup: aluminium 750 cc

Ref. 8025**

Cup: plastic gray cup anti-UV 680 cc

Ref. 8020**/UV

- Body: die-casting magnesium and Kevlar fiber
- Trigger: Kevlar fiber
- Air cap: chemically nicked plated brass
- Air cap ring: Kevlar fiber
- Nozzle: AISI 303 stainless steel
- Needle-spring: stainless steel
- Seal gaskets: self-lubricating and adjustable PTFE (Teflon)

• **Weight: 380 g**

• Operating air pressure: 2.0 - 2.5 bar

• Air consumption: 265 - 290 l/min

• Ø nozzle: 1.0 - 1.2 - 1.3 - 1.5 - 1.7 - 1.9 - 2.2 - 2.5



BASE COAT
CLEAR COAT
PRIMER

Note:
add nozzle Ø to Ref. (**)



Slim KOMBAT HTE

Spraygun only

Ref. 8060**

- Body: die-casting magnesium and Kevlar fiber
- Trigger: Kevlar fiber
- Air cap: chemically nicked plated brass
- Air cap ring: Kevlar fiber
- Nozzle: AISI 303 stainless steel
- Needle-spring: stainless steel
- Seal gaskets: self-lubricating and adjustable PTFE (Teflon)

• **Weight: 380 g**

• Operating air pressure: 2.0 - 2.5 bar

• Air consumption: 265 - 290 l/min

• Ø nozzle: 1.0 - 1.2 - 1.3 - 1.5 - 1.7 - 1.9 - 2.2 - 2.5



BASE COAT
CLEAR COAT
PRIMER

Note:
add nozzle Ø to Ref. (**)



TYPE

ITEM ID

RECOMMENDED USE

Slim KOMBAT HVLP

Cup: POM C 680 cc

Ref. 8130**

Cup: aluminium 750 cc

Ref. 8135**

Cup: plastic gray cup anti-UV 680 cc

Ref. 8130**/UV

- Body: die-casting magnesium and Kevlar fiber
- Trigger: Kevlar fiber
- Air cap: chemically nicked plated brass
- Air cap ring: Kevlar fiber
- Nozzle: AISI 303 stainless steel
- Needle-spring: stainless steel
- Seal gaskets: self-lubricating and adjustable PTFE (Teflon)

• **Weight: 380 g**

- Operating air pressure: 2.0 - 2.5 bar
- Air consumption: 265 - 290 l/min
- Ø nozzle: 1.0 - 1.2 - 1.3 - 1.5 - 1.7 - 1.9 - 2.2 - 2.5

Air inlet pressure regulator with pressure gauge

BASE COAT
CLEAR COAT
PRIMER

Note:
add nozzle Ø to Ref. (**)



Slim KOMBAT HVLP

Cup: POM C 680 cc

Ref. 8120**

Cup: aluminium 750 cc

Ref. 8125**

Cup: plastic gray cup anti-UV 680 cc

Ref. 8125**/UV

- Body: die-casting magnesium and Kevlar fiber
- Trigger: Kevlar fiber
- Air cap: chemically nicked plated brass
- Air cap ring: Kevlar fiber
- Nozzle: AISI 303 stainless steel
- Needle-spring: stainless steel
- Seal gaskets: self-lubricating and adjustable PTFE (Teflon)

• **Weight: 380 g**

- Operating air pressure: 2.0 - 2.5 bar
- Air consumption: 265 - 290 l/min
- Ø nozzle: 1.0 - 1.2 - 1.3 - 1.5 - 1.7 - 1.9 - 2.2 - 2.5



BASE COAT
CLEAR COAT
PRIMER

Note:
add nozzle Ø to Ref. (**)



Slim KOMBAT HVLP

Spraygun only

Ref. 8160**

- Body: die-casting magnesium and Kevlar fiber
- Trigger: Kevlar fiber
- Air cap: chemically nicked plated brass
- Air cap ring: Kevlar fiber
- Nozzle: AISI 303 stainless steel
- Needle-spring: stainless steel
- Seal gaskets: self-lubricating and adjustable PTFE (Teflon)

• **Weight: 380 g**

- Operating air pressure: 2.0 - 2.5 bar
- Air consumption: 265 - 290 l/min
- Ø nozzle: 1.0 - 1.2 - 1.3 - 1.5 - 1.7 - 1.9 - 2.2 - 2.5



BASE COAT
CLEAR COAT
PRIMER

Note:
add nozzle Ø to Ref. (**)

